

NEW DENTIST LOUNGE
(14,040 sqft)

Inventory as of 11/12/2020

Dimension	Size	Qty	SqFt	Rented	Available
10'x10'	100	96	9,600	1	95
30'x40'	1,200	1	1,200	1	0
40'x40'	1,600	1	1,600	1	0
Totals:		98	12,400	3	95

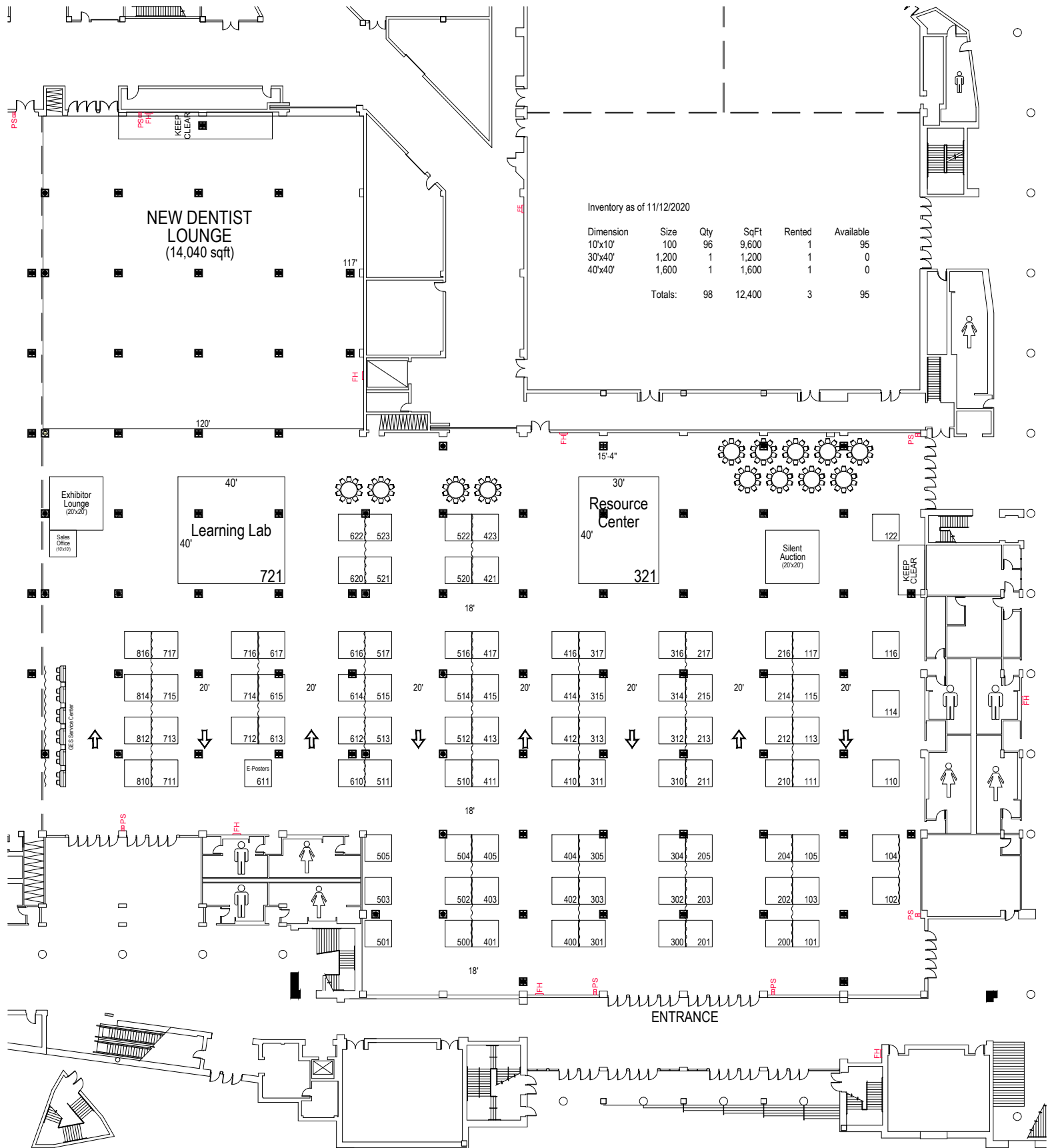

Academy of General Dentistry Scientific Session
June 10 - 12, 2021
Austin Convention Center - Halls 1 & 2

EVERY EFFORT HAS BEEN MADE TO INSURE THE ACCURACY OF ALL INFORMATION CONTAINED ON THIS FLOOR PLAN. HOWEVER, NO WARRANTIES, EXPRESS OR IMPLIED, ARE MADE WITH RESPECT TO THIS FLOOR PLAN, IF THE LOCATION OF BUILDING COLUMNS, UTILITIES, OR OTHER ARCHITECTURAL COMPONENTS OF THE FACILITY IS A CONSIDERATION IN THE CONSTRUCTION OR USAGE OF AN EXHIBIT, IT IS THE SOLE RESPONSIBILITY OF THE EXHIBITOR TO PHYSICALLY INSPECT THE FACILITY TO VERIFY ALL DIMENSIONS AND LOCATIONS.

COPYRIGHT © BY GLOBAL EXPERIENCE SPECIALISTS. ALL RIGHTS RESERVED. NO PART OF THIS PUBLICATION MAY BE REPRODUCED, STORED IN ANY RETRIEVAL SYSTEM, OR TRANSMITTED IN ANY FORM OR BY ANY MEANS - ELECTRONIC, MECHANICAL, PHOTOCOPIING, RECORDING, OR OTHERWISE - WITHOUT EXPRESS WRITTEN CONSENT OF GLOBAL EXPERIENCE SPECIALISTS.



File: agd-2106-austcc.dwg
Plotted: Nov 12, 2020
By: JORGES